

# In-Line Filter

# LC60



## Features and Benefits (LC60)

- Compact design allows for in-line installation.
- Small profile allows filter to be mounted in tight areas.
- Quick and easy cartridge element change outs.
- Durable, compact design.
- Uses 10 micron stainless steel wire mesh filtration.
- Perfect for pilot pressure circuits and pressure compensated pump protection.

**8 gpm**  
**30 L/min**  
**6000 psi**  
**415 bar**

NF30  
 NFS30  
 YF30  
 CFX30  
 PLD  
 CF40  
 DF40  
 PF40  
 RFS50  
 RF60  
 CF60

Model No. of filter in photograph is LC601SSD10S.

Flow Rating:	Up to 8 gpm (30 L/min) for 150 SUS (32 cSt) fluids
Max. Operating Pressure:	6000 psi (414 bar)
Min. Yield Pressure:	18000 psi (1241 bar), per NFPA T2.6.1
Rated Fatigue Pressure:	6000 psi (414 bar), per NFPA T2.6.1
Temp. Range:	-20°F to 225°F (-29°C to 107°C)
Porting Head:	Steel
Element Case:	Steel
Weight:	0.93 lbs. (0.42 kg)
Element Change Clearance:	2.50" (63.5 mm)
Type Fluid	Appropriate Schroeder Media
Petroleum Based Fluids	All Stainless Steel Wire Mesh
Invert Emulsions	10 μ Stainless Steel Wire Mesh
Water Glycols	10 μ Stainless Steel Wire Mesh

## Filter Housing Specifications

CTF60  
 VF60  
 LW60  
 KF30  
 KF50  
 TF50

## Fluid Compatibility

KC50  
 MKF50  
 MKC50

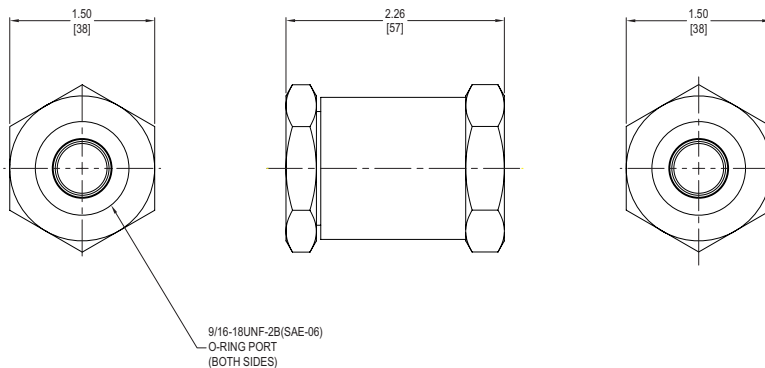

KC65  
 HS60  
 MHS60  
 KFH50

## LC60

LC35  
 LC50  
 NOF30-05

NOF-50-760  
 FOF60-03

NMF30  
 RMF60

14-CRZX10  
 20-CRZX10

Metric dimensions in ( ).  
 Dimensions shown are inches (millimeters) for general information and overall envelope size only.  
 For complete dimensions please contact Schroeder Industries to request a certified print.

### Element Performance Information & Dirt Holding Capacity

Element	Filtration Ratio Per ISO 4572/NFPA T3.10.8.8 Using automated particle counter (APC) calibrated per ISO 4402			Filtration Ratio per ISO 16889 Using APC calibrated per ISO 11171	
	$\beta_x \geq 75$	$\beta_x \geq 100$	$\beta_x \geq 200$	$\beta_{x(c)} \geq 200$	$\beta_{x(c)} \geq 1000$

**\*Please contact manufacture for more details\***

### Pressure Drop Information Based on Flow Rate and Viscosity

$\Delta P_{\text{housing}}$

LC60  $\Delta P_{\text{housing}}$  for fluids with sp gr (specific gravity) = 0.86:

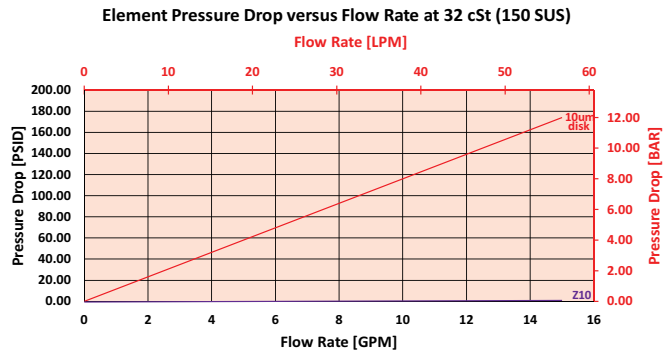

### Filter Model Number Selection

#### How to Build a Valid Model Number for a Schroeder LC60:

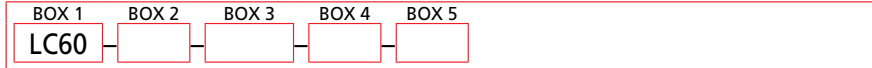

Example:

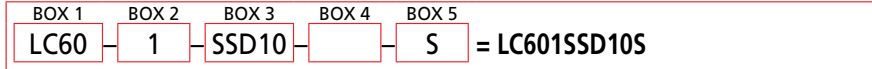

BOX 1 <b>Filter Series</b> LC60	BOX 2 <b>Number of Elements</b> 1	BOX 3 <b>Element Part Number</b> SSD10 = 10 μ Stainless Steel Wire Mesh
BOX 4 <b>Seal Material</b> Omit = Buna N	BOX 5 <b>Porting</b> S = SAE-6	